



ROSENTHAL

3008 COLUMBIA PIKE

Arlington, Virginia

www.rosenthalproperties.com



PROPERTY FEATURES:

- **RETAIL IS 100% LEASED**
- Visibility to over 27,000 cars per day on Columbia Pike
- Walk score of 91
- Parking: Eight dedicated retail parking spaces
- Located in the heart of the Columbia Pike Revitalization District at the intersection of Columbia Pike and S. Walter Reed
- 8.6 million square feet of office within 2 miles
- Daytime population of +150,000 within 3 miles
- Located a short distance to Old Town Alexandria, Crystal City, Clarendon, Ballston and Washington, DC

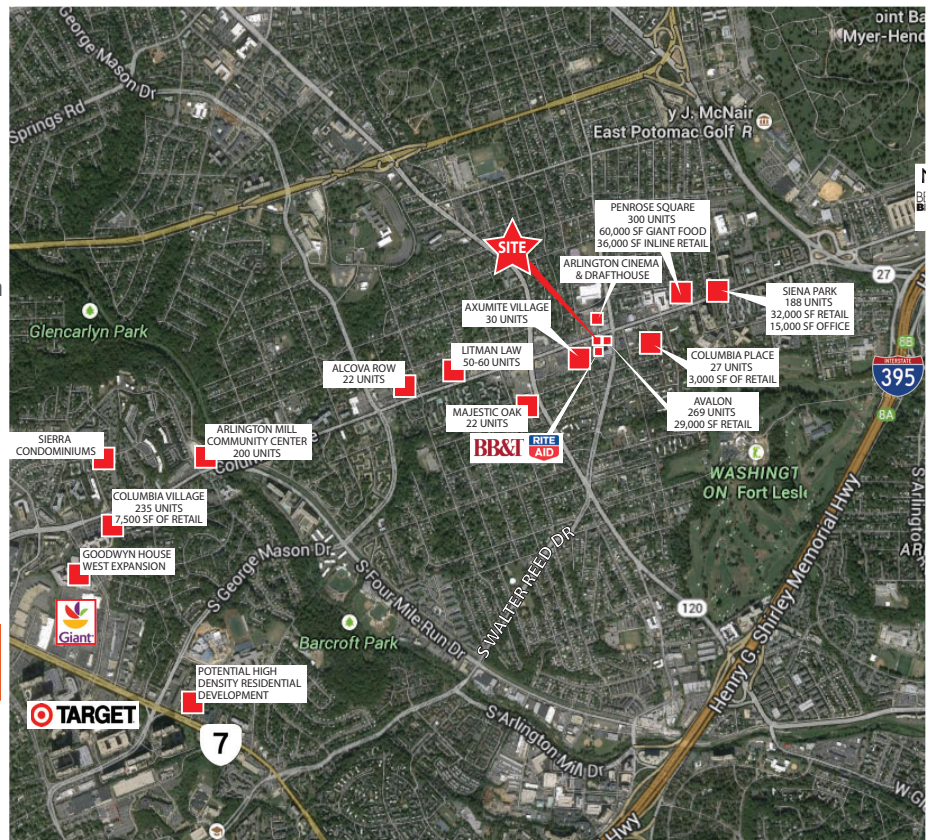

	Population	Avg HH Income	Daytime Population
1 Mile	31,697	\$113,544	7,956
3 Miles	276,010	\$124,795	154,457
5 Miles	676,670	\$129,209	728,990

CONTACT

Nora Foley or Billy Orlovel Phone: **703.893.5141** | Email: leasing@rosenthalproperties.com



ROSENTHAL

3008 COLUMBIA PIKE

Arlington, Virginia

www.rosenthalproperties.com

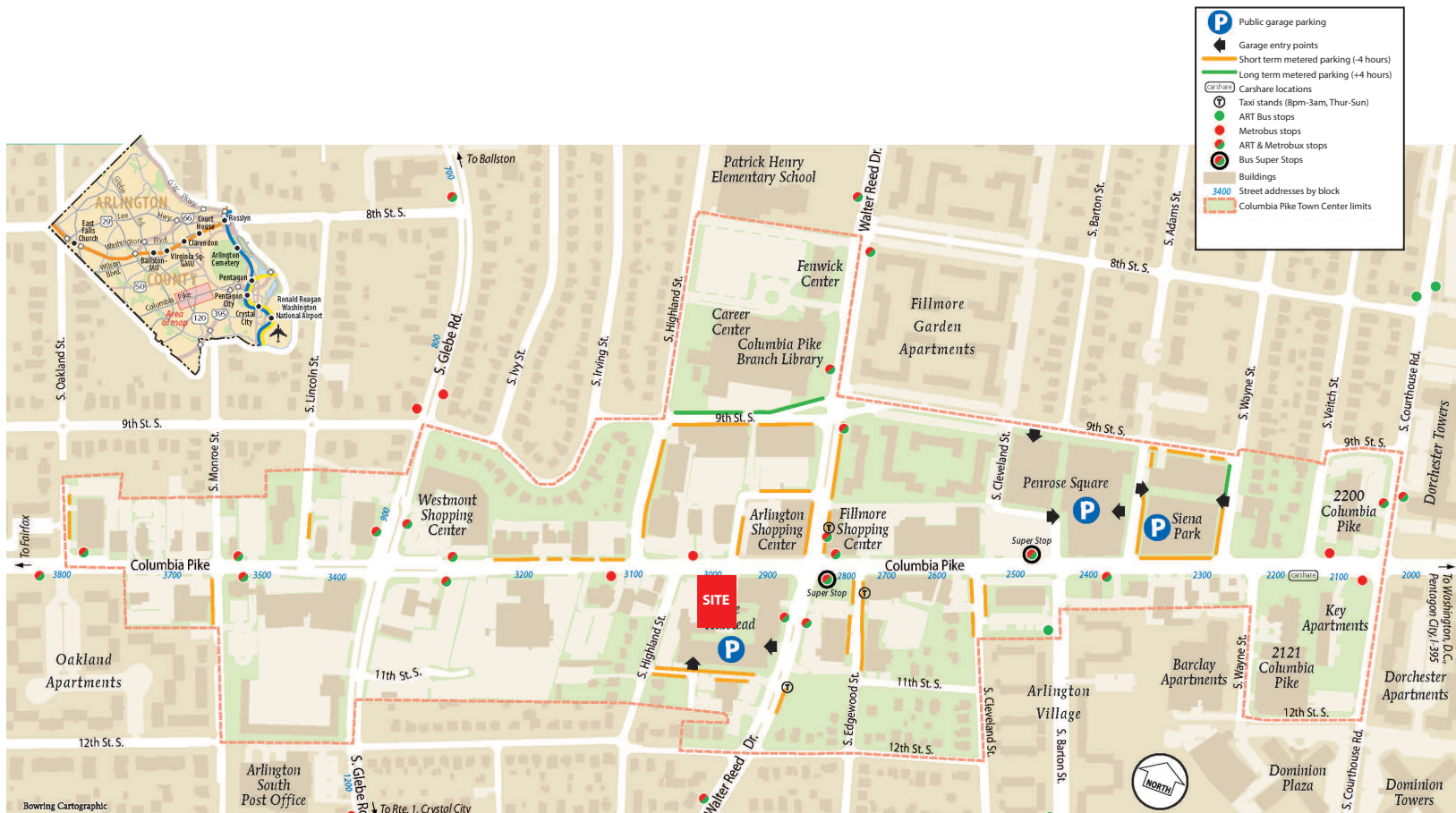
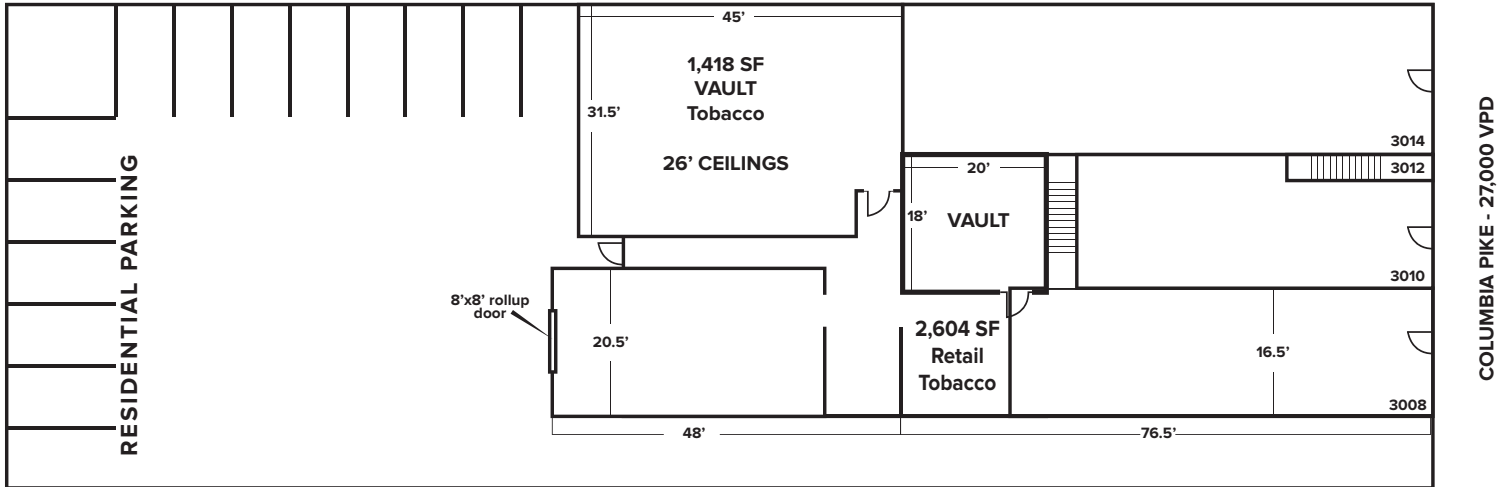

CONTACT Nora Foley or Billy Orlove | Phone: 703.893.5141 | Email: leasing@rosenthalproperties.com