



# ROSENTHAL

## 6300 LEESBURG PIKE

Falls Church, Virginia

[www.rosenthalproperties.com](http://www.rosenthalproperties.com)



### PROPERTY FEATURES:

- **1,900 SF RETAIL SPACE FOR LEASE**
- **655 - 2,502 SF OFFICE SPACES FOR LEASE**
- Located on Route 7 near the busy intersection of Arlington Blvd, Leesburg Pike and Wilson Blvd
- Exterior building signage available
- Highly visible to over 42,000 VPD on Leesburg Pike and 48,000 VPD on Route 50
- Adjacent to SunTrust Bank and Seven Corners Center

	Population	Avg HH Income	Daytime Population
1 Mile	23,525	\$123,910	8,931
3 Miles	211,100	\$132,737	83,110
5 Miles	562,946	\$128,271	272,662

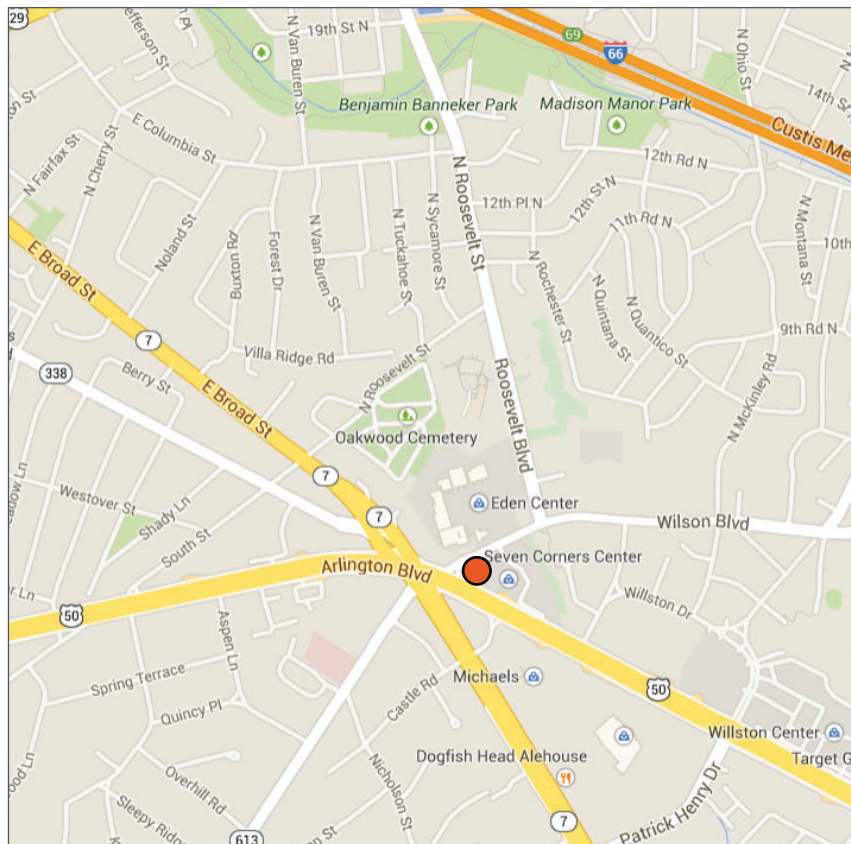

CONTACT

**Billy Orlove or Jane Le** | Phone: 703.893.5141 | Email: [leasing@rosenthalproperties.com](mailto:leasing@rosenthalproperties.com)



# ROSENTHAL

## 6300 LEESBURG PIKE

Falls Church, Virginia

[www.rosenthalproperties.com](http://www.rosenthalproperties.com)

### STREET LEVEL RETAIL

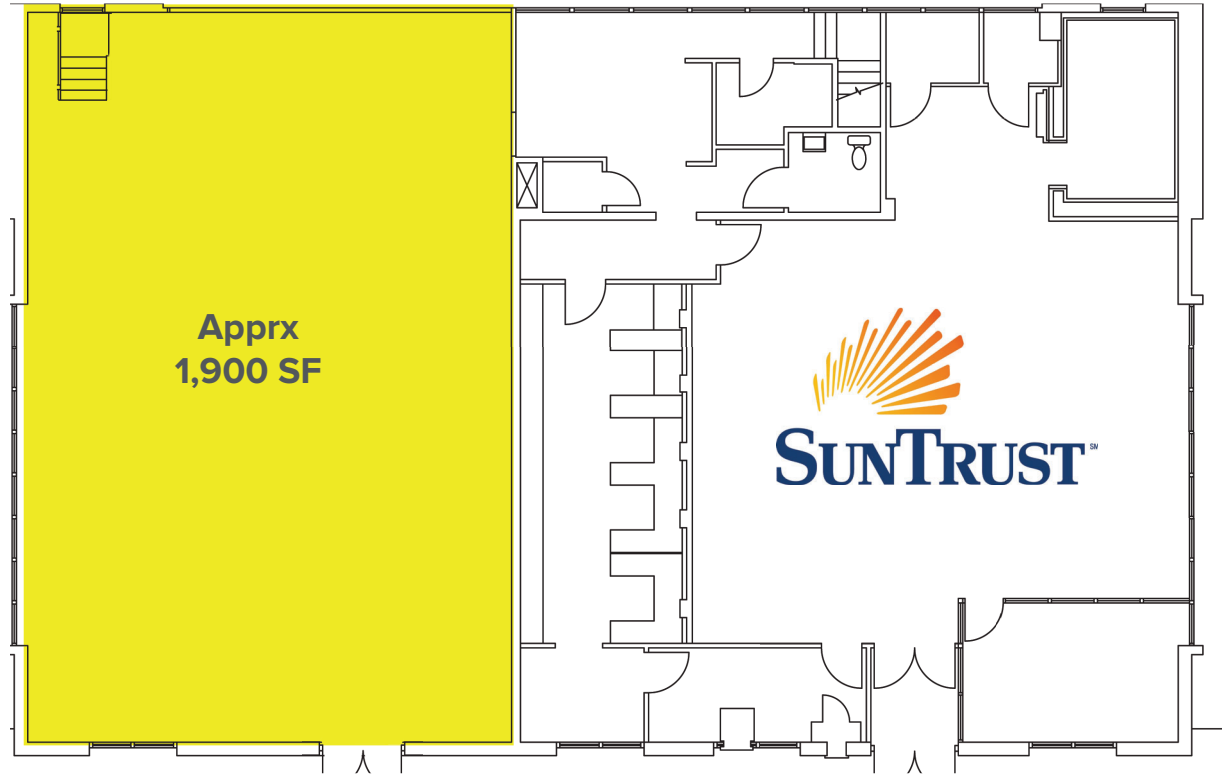

### GROUND LEVEL OFFICE

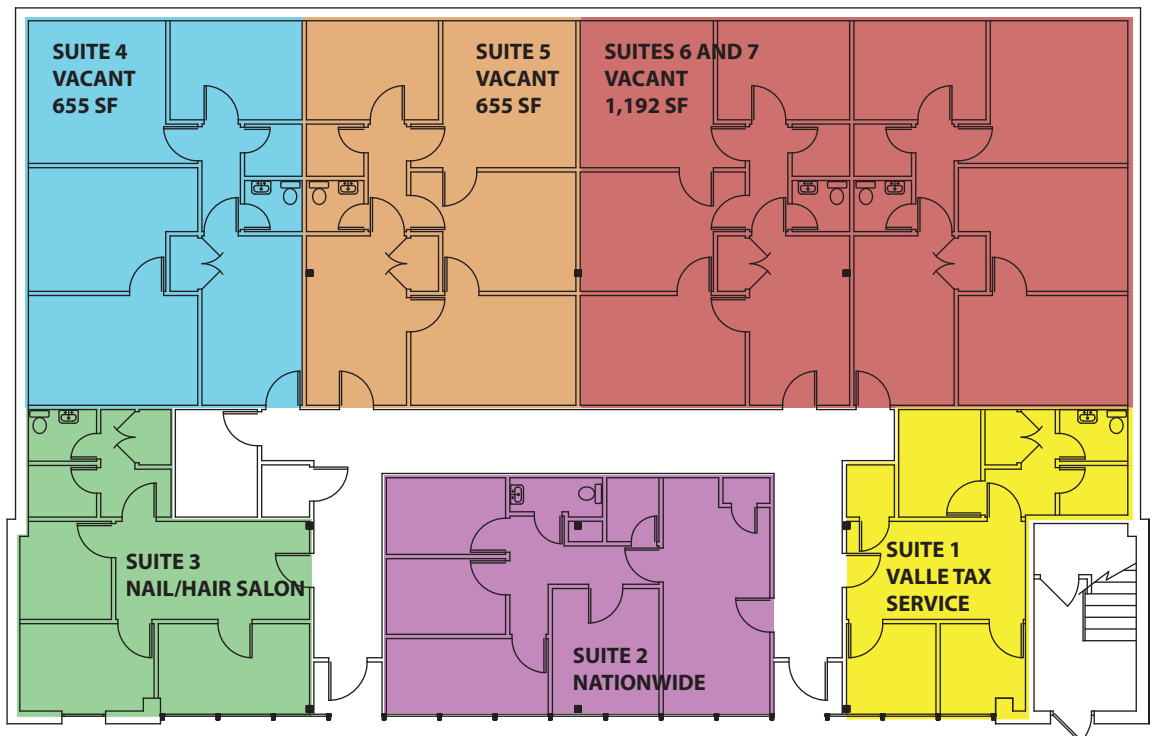

CONTACT

Billy Orlove or Jane Le | Phone: 703.893.5141 | Email: [leasing@rosenthalproperties.com](mailto:leasing@rosenthalproperties.com)